

AWWA CLASS "F" SLIP-ON FLANGE (300 PSI)

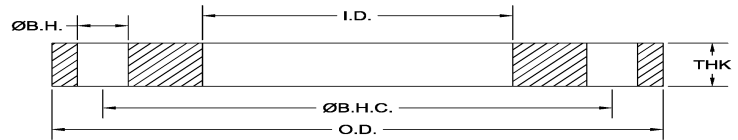

Examples: 4" IPS Class F Flange
 Carbon Part # 1028F-04I
 304 Part# 1028F-S4-04I
 316 Part# 1028F-S6-04I

Parts Available:
 Meets ANSI class 300 pattern
 Carbon Steel (C/S) AWWA C207
 Stainless Steel (S/S) AWWA C228
 304/304L and 316/316L

PART NO.	SIZE	ID	OD	B.H.C. DIA.	B.H. DIA	#B.H.	THK	WEIGHT IN LBS.
1028F-04I	4"	4.57	10.00	7.88	0.88	8	1.13	18.40
1028F-05I	5"	5.66	11.00	9.25	0.88	8	1.21	22.30
1028F-06I	6"	6.73	12.50	10.62	0.88	12	1.31	29.70
1028F-08I	8"	8.72	15.00	13.00	1.00	12	1.31	39.90
1028F-10I	10"	10.88	17.50	15.25	1.13	16	1.50	56.00
1028F-12I	12"	12.88	20.50	17.75	1.25	16	1.63	83.00
1028F-14	14"	14.19	23.00	20.25	1.25	20	1.94	128.00
1028F-16	16"	16.19	25.50	22.50	1.38	20	2.14	166.80
1028F-18	18"	18.19	28.00	24.75	1.38	24	2.25	204.20
1028F-20	20"	20.19	30.50	27.00	1.38	24	2.33	247.40
1028F-22	22"	22.19	33.00	29.25	1.38	24	2.50	306.70
1028F-24	24"	24.19	36.00	32.00	1.63	24	2.69	387.60
1028F-26	26"	26.19	38.25	34.50	1.88	28	3.00	451.00
1028F-28	28"	28.19	40.75	37.00	1.88	28	3.13	532.20
1028F-30	30"	30.19	43.00	39.25	1.88	28	3.15	585.70
1028F-32	32"	32.19	45.25	41.50	1.88	28	3.25	657.50
1028F-34	34"	34.19	47.50	43.50	1.88	28	3.38	840.70
1028F-36	36"	36.19	50.00	46.00	2.13	32	3.46	801.90
1028F-38	38"	38.19	52.25	48.00	2.13	32	3.50	874.30
1028F-40	40"	40.19	54.25	50.25	2.13	36	3.63	937.40
1028F-42	42"	42.19	57.00	52.75	2.13	36	3.81	1103.40
1028F-44	44"	44.19	59.25	55.00	2.13	36	4.00	1237.20
1028F-46	46"	46.19	61.50	57.25	2.13	40	4.13	1360.80
1028F-48	48"	48.19	65.00	60.75	2.13	40	4.50	1736.80