

## 1020 - 1/2" THICK LIGHTWEIGHT FLANGE

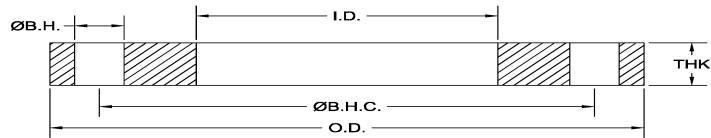

Examples: 12" IPS Flange  
 Carbon Part # 1020-12I  
 304 Part# 1020-S4-12I  
 316 Part# 1020-S6-12I

Parts Available:  
 Meets ANSI class 150 pattern  
 Carbon Steel (C/S) C207  
 Stainless Steel (S/S)  
 304/304L and 316/316L

PART NO.	SIZE	ID	OD	B.H.C. DIA.	B.H. DIA	#B.H.	THK	WEIGHT IN LBS.
1020-02I	2" IPS	2.44	6.00	4.75	0.75	4	0.50	3.00
1020-02D	2" TUBE	2.06	6.00	4.75	0.75	4	0.50	3.50
1020-025I	2.50" IPS	2.94	7.00	5.50	0.75	4	0.50	4.20
1020-025D	2.50" TUBE	2.56	7.00	5.50	0.75	4	0.50	4.50
1020-03I	3" IPS	3.57	7.50	6.00	0.75	4	0.50	4.70
1020-03D	3" TUBE	3.06	7.50	6.00	0.75	4	0.50	5.30
1020-035I	3.50" IPS	4.07	8.50	7.00	0.75	8	0.50	5.50
1020-035D	3.50" TUBE	3.56	8.50	7.00	0.75	8	0.50	6.00
1020-04I	4" IPS	4.57	9.00	7.50	0.75	8	0.50	6.40
1020-04D	4" TUBE	4.06	9.00	7.50	0.75	8	0.50	6.90
1020-050I	5" IPS	5.66	10.00	8.50	0.88	8	0.50	7.20
1020-05D	5" TUBE	5.06	10.00	8.50	0.88	8	0.50	7.70
1020-06I	6" IPS	6.75	11.00	9.50	0.88	8	0.50	8.40
1020-06D	6" TUBE	6.09	11.00	9.50	0.88	8	0.50	9.00
1020-08I	8" IPS	8.72	13.50	11.75	0.88	8	0.50	11.40
1020-08D	8" TUBE	8.09	13.50	11.75	0.88	8	0.50	12.60
1020-10I	10" IPS	10.88	16.00	14.25	1.00	12	0.50	14.60
1020-10D	10" TUBE	10.12	16.00	14.25	1.00	12	0.50	16.30
1020-12I	12" IPS	12.88	19.00	17.00	1.00	12	0.50	21.60
1020-12D	12" TUBE	12.12	19.00	17.00	1.00	12	0.50	22.50
1020-14	14"	14.19	21.00	18.75	1.13	12	0.50	25.00
1020-16	16"	16.19	23.50	21.25	1.13	16	0.50	34.00
1020-18	18"	18.19	25.00	22.75	1.25	16	0.50	30.00
1020-20	20"	20.19	27.50	25.00	1.25	20	0.50	36.00
1020-22	22"	22.19	29.50	27.25	1.38	20	0.50	40.00
1020-24	24"	24.19	32.00	29.50	1.38	20	0.50	45.00